

Load Type and Capacity - Switches

Model Number	Description	Voltage	Load Type	Minimum Load	Maximum Load ³		
					Not Ganged	End of Gang	Middle of Gang
PD-5WS-DV ¹	Two-wire switch	120 V~	Incandescent/ Halogen	25 W	600 W	450 W	350 W
		277 V~	Incandescent/ Halogen	25 W	1350 W	1100 W	800 W
		120 V~	MLV	25 W	600 VA/475 W	450 VA/350 W	350 VA/275 W
		277 V~	MLV	25 W	1350 VA/1075 W	1100 VA/875 W	800 VA/625 W
		120 V~	General Purpose Fan	0.4 A	3 A	3 A	3 A
		120/277 V~	LED	Use LUT-MLC ²	5 A	4 A	3 A
		120/277 V~	Fluorescent	Use LUT-MLC ²	5 A	4 A	3 A
		120 V~	ELV	Use LUT-MLC ²	600 W	450 W	350 W
		277 V~	ELV	Use LUT-MLC ²	1350 W	1100 W	800 W
PD-6ANS	Neutral-wire switch (Neutral Connection Required)	120 V~	Incandescent/ Halogen	10 W	720 W	720 W	600 W
			MLV	10 W	720 VA	720 VA	600 VA
			Fan	0.1 A	3.6 A	3.6 A	3.6 A
			LED	1 bulb	6 A	6 A	5 A
			Fluorescent	1 ballast	6 A	6 A	5 A
			ELV	10 W	720 VA	720 VA	600 VA
			PHPM-SW	1 interface	3 interface	3 interface	3 interface

¹ No Neutral Required.

² To ensure proper operation of the switch with LED, fluorescent, and ELV loads, a LUT-MLC may be required, especially at lower wattages. If the status LED on the switch is flashing or solid red in color, a LUT-MLC must be installed. To guarantee best performance, installing a LUT-MLC with these load types regardless of wattage is recommended. Rarely, some load types may still flicker or glow in the off state even with the LUT-MLC installed, in which case a different load may be required or additional LUT-MCCs.

³ See "Ganging and Derating" section.

Job Name:	Model Numbers:
Job Number:	

Model Number	Description	Voltage	Load Type	Minimum Load	Maximum Load			
					Not Ganged	End of Gang	Middle of Gang	
PD-10NXD	Wireless In-Wall Dimmer PRO (Neutral Connection Required for Certain load types) ⁴	120 V~	Incandescent/Halogen	10 W with neutral (25 W without neutral)	1000 W	800 W	600 W	
			MLV Halogen	10 W	1000 VA	800 VA	600 VA	
			MLV LED	See Application Note #559				
			CFL/LED (120 V~ Rated) ³	1 bulb ³	250 W	250 W	250 W	
			Hi-lume® 1% 2-Wire LED drivers	1 driver	1000 W (13 drivers)	800 W (13 drivers)	600 W (13 drivers)	
			Dimmable Ballasts ⁵	1 ballast	1000 VA	800 VA	600 VA	
			PHPM-PA/3F	1 interface	3 interface	3 interface	3 interface	
PD-3PCL ¹	Wireless Plug-In Lamp Dimmer	120 V~	Incandescent/Halogen	10 W	300 W	N/A	N/A	
			CFL/LED (120 V~ Rated) ³		100 W	N/A	N/A	
PD-5NE	Phase Selectable Dimmer (Neutral Connection Required)	120 V~	Incandescent/Halogen	10 W	500 W	400 W	300 W	
			CFL/LED (120 V~ Rated) ³		250 W	250 W	250 W	
			MLV Halogen ²		400 VA	400 VA	400 VA	
			ELV Halogen		500 W	400 W	300 W	
			Hi-lume® 1% 2-Wire LED drivers	1 driver	400 W (20 drivers)	400 W (20 drivers)	400 W (20 drivers)	
			Dimmable Ballasts ⁵	1 ballast	400 VA	400 VA	400 VA	
			PHPM-PA/3F	1 interface	3 interface	3 interface	3 interface	
			ELV LED	See Application Note #559				
			MLV LED	See Application Note #559				
PD-6WCL	Wireless In-Wall Dimmer	120 V~	Incandescent/Halogen	25 W	600 W	500 W	400 W	
			CFL/LED (120 V~ Rated) ³		150 W	150 W	150 W	

¹ Caséta® Wireless Plug-In Lamp Dimmer can not be ganged.

² Will need to change load type to MLV. See www.casetawireless.com/change_phase.

³ See bulb list at www.lutron.com/led.

⁴ For PD-10NXD, a neutral connection is required for MLV loads, LED drivers, dimmable ballasts, and power modules (PHPM-PA, PHPM-3F, and GRX-TVI).

⁵ Compatible dimmable ballasts include Tu-Wire®, Mark X, and PowerSense®.

PowerSense is a registered trademark of Osram Sylvania.

Job Name:	Model Numbers:
Job Number:	

Ganging and Derating

When ganging with other switches/dimmers in the same wallbox, derating is required. See “Load Type and Capacity” charts.

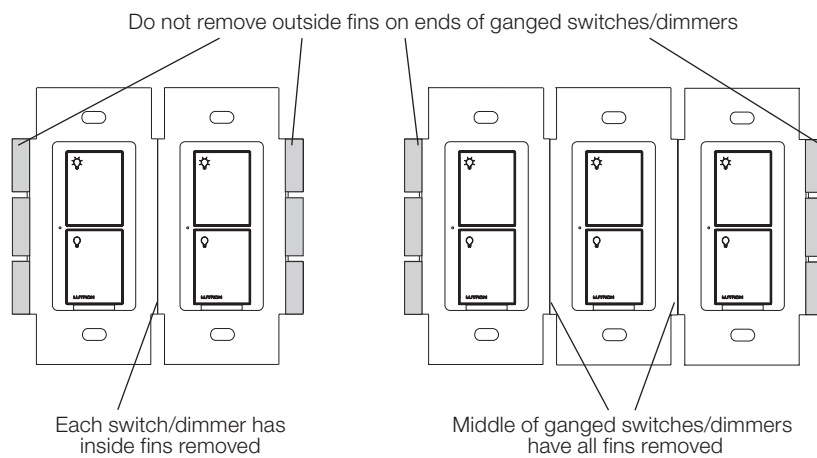
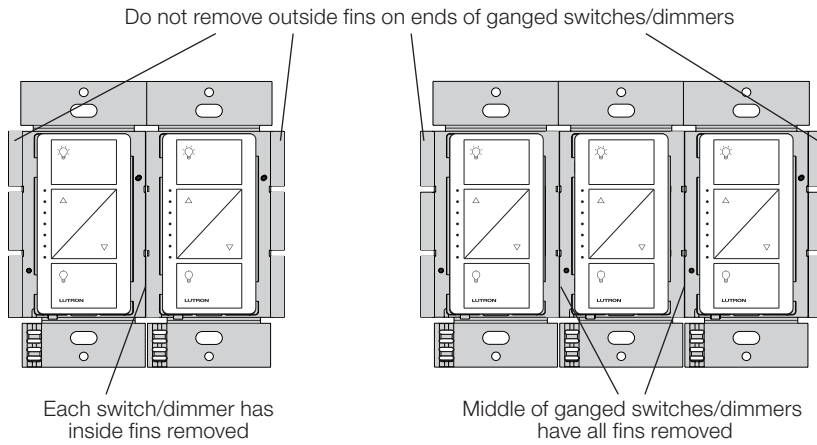

Job Name:	Model Numbers:
Job Number:	